

CORNER RECORD

COUNTY OF PLACER, CALIFORNIA

City of \_\_\_\_\_

Document Number \_\_\_\_\_

Brief Legal Description Lot 9, Lakeview Subdivision, Book "E" Maps, Page 49

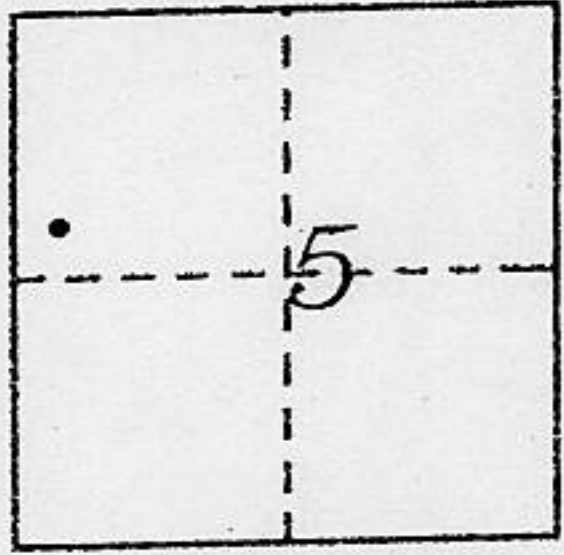

T.15N., R.17E.

CORNER TYPE

COORDINATES (Optional)

Government Corner   
Meander   
Rancho   
Date of Survey \_\_\_\_\_

Control   
Property   
Other

N. \_\_\_\_\_  
E. \_\_\_\_\_  
Zone \_\_\_\_\_ Datum \_\_\_\_\_  
Elev. \_\_\_\_\_

Corner— Left as found  Found and tagged  Established  Reestablished  Rebuilt

Identification and type of corner found: Evidence used to identify or procedure used to establish or reestablish corner:

● ~ found 1/2" pin, as per "E" Maps 49,  
unless otherwise noted.

A description of the physical condition of the monument as found and as set or reset:

∅ ~ set 5/8" rebar with 2" aluminum cap stamped LS 5886

SURVEYOR'S STATEMENT

This Corner Record was prepared by me or under my direction in conformance with the Land

Surveyor's Act on January 2002

Signed [Signature] L.S. or R.C.E. Number 5886

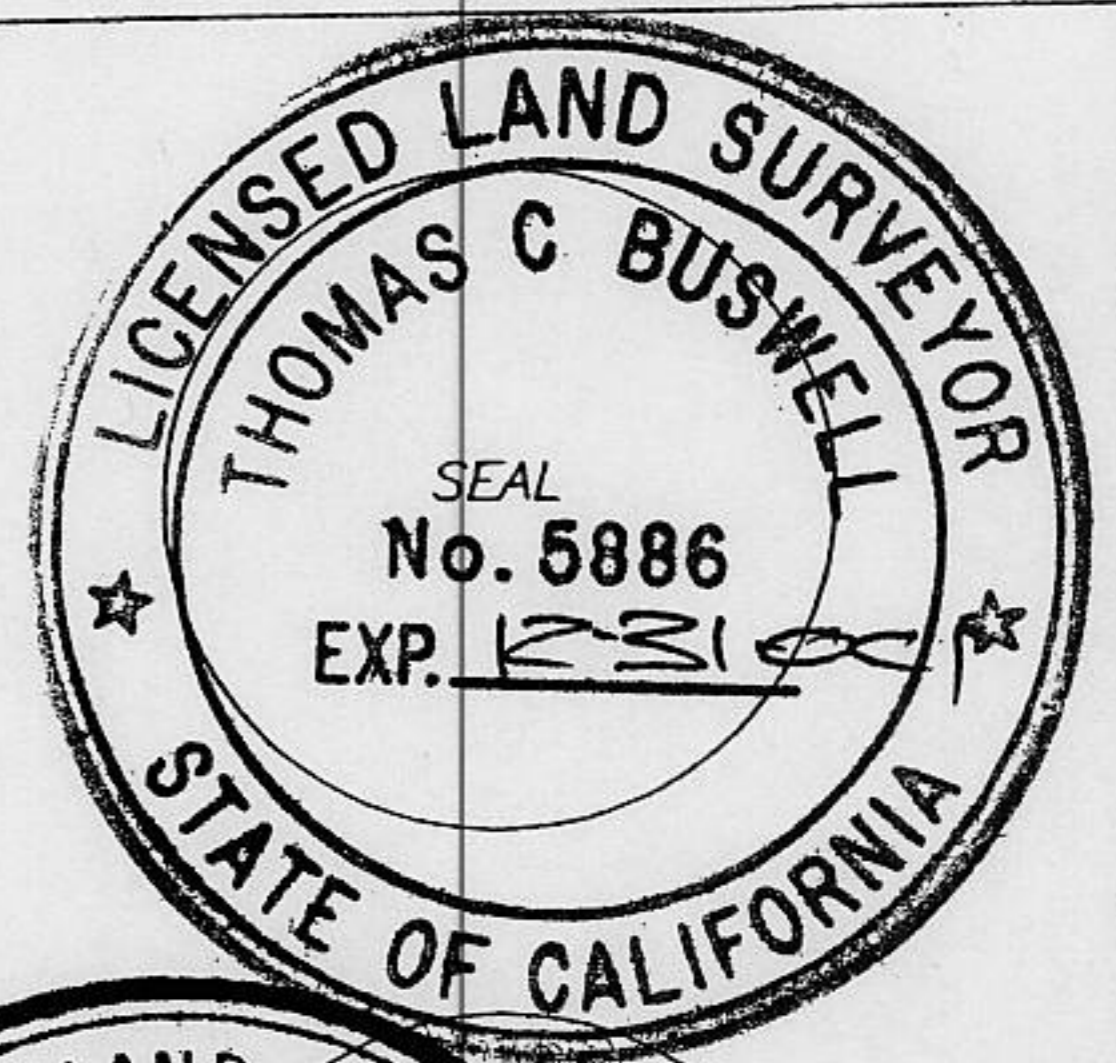

COUNTY SURVEYOR'S STATEMENT

This Corner Record was Received Jan. 24<sup>TH</sup> 2002 and Examined

and filed MARCH 20, 2002

Signed [Signature] Title County Surveyor

County Surveyor's Comment \_\_\_\_\_

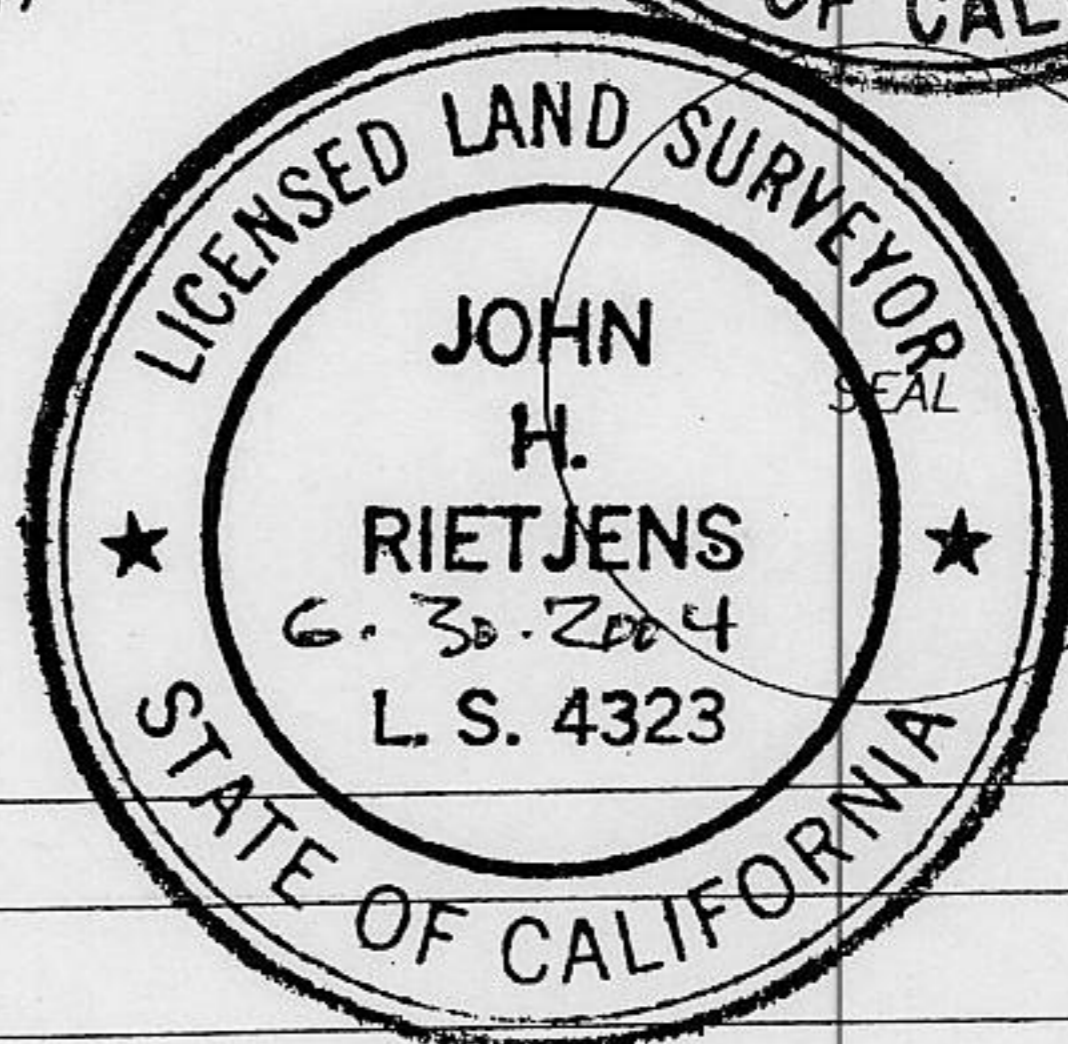

BOOK 7 CORNER RECORDS PAGE 49

