

CORNER RECORD

Document Number _____

City of UNINCORPORATED AREA

County of PLACER, California

Brief Legal Description LOT 240 ALPINE MEADOWS ESTATES UNIT NO. 8
BOOK "I" OF MAPS PAGE 53 P.C.R.

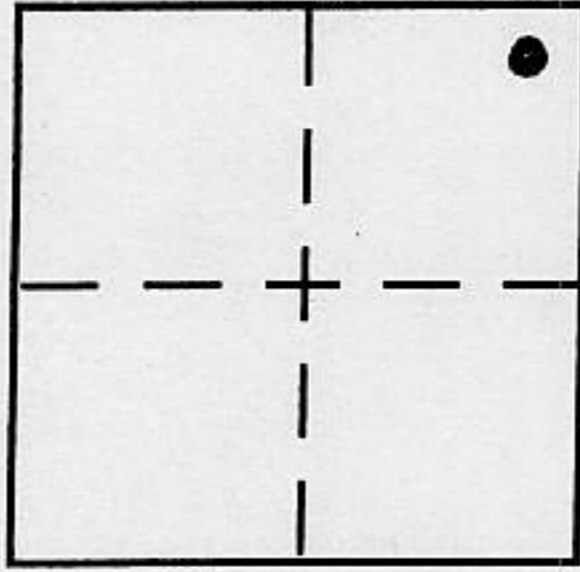

SEC. 4
T. 15 N.
R. 16 E.
M.D.M.

CORNER TYPE

Government Corner Control
 Meander Property
 Rancho Other
 Date of Survey 11-15-00

COORDINATES (Optional)

N. _____
 E. _____
 Zone _____ NAD27 NAD83
 NAD83 Epoch _____
 Elev. _____
 Vert. Datum: NGVD29 NAVD88
 Meas. Units: Metric Imperial

Corner - Left as found Found and tagged Established Reestablished Rebuilt

Identification and type of corner found: Evidence used to identify or procedure used to establish or reestablish the corner:

● = FOUND 5/8" REBAR, PER "I"/MAPS/53.
 ○ = FOUND RAILROAD SPIKE, PER "I"/MAPS/53.

A description of the physical condition of the monument as found and as set or reset:

○ = SET 3/4" IRON PIPE W/PLASTIC PLUG, L.S. 5549
 ○ = SET NAIL + TAG, L.S. 5549

JN. 00346

SURVEYOR'S STATEMENT

This Corner Record was prepared by me or under my direction in conformance with the Land Surveyor's Act on NOVEMBER 16 2000

Signed Charles R. Sage Jr. P.L.S or R.C.E. No. L.S. 5549
LIC. EXPIRES 6-30-01

COUNTY SURVEYOR'S STATEMENT

This Corner Record was received DECEMBER 27, 2000

and examined and filed DECEMBER 18, 2001

Signed John H. Rietsjens P.L.S or R.C.E. No. 4323

Title COUNTY SURVEYOR

County Surveyor's Comment _____

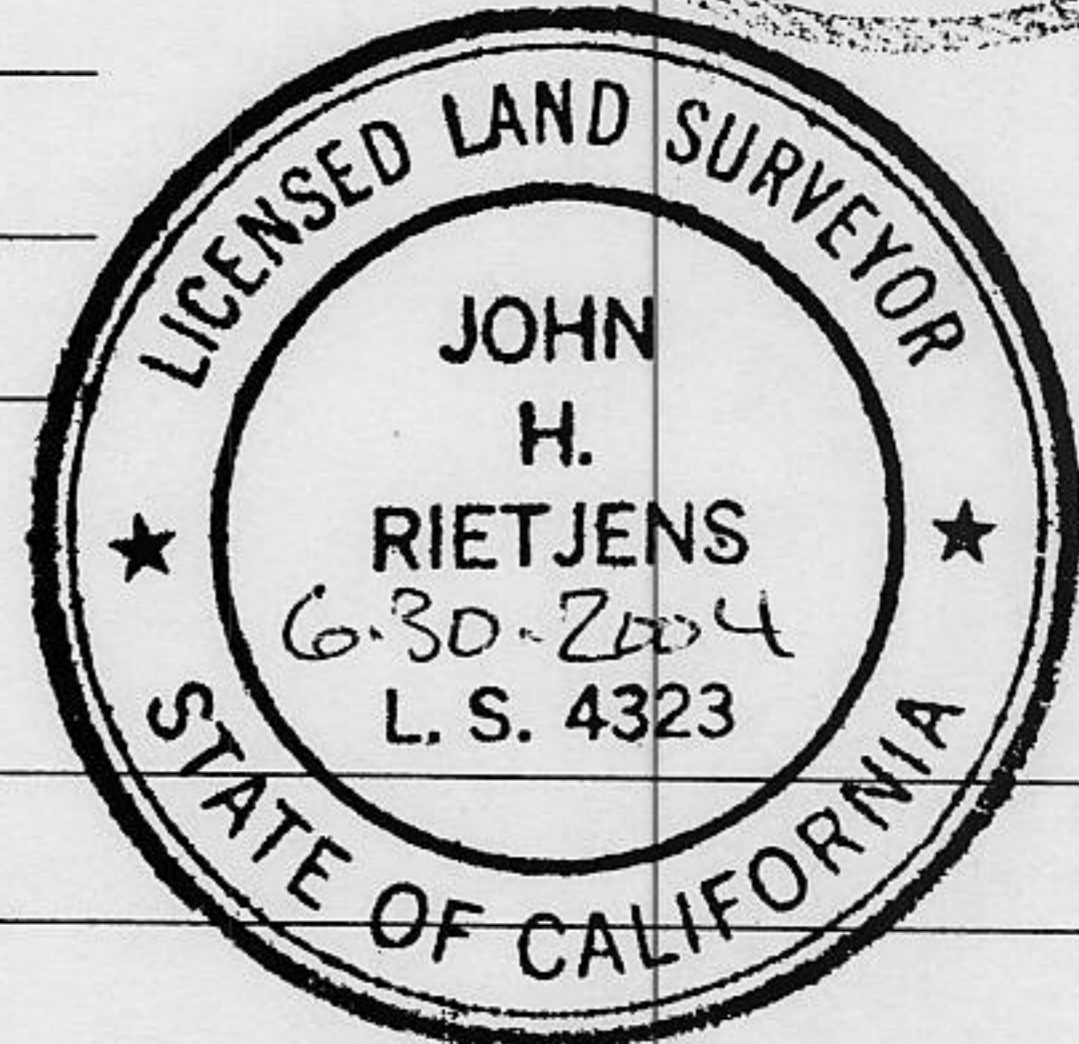
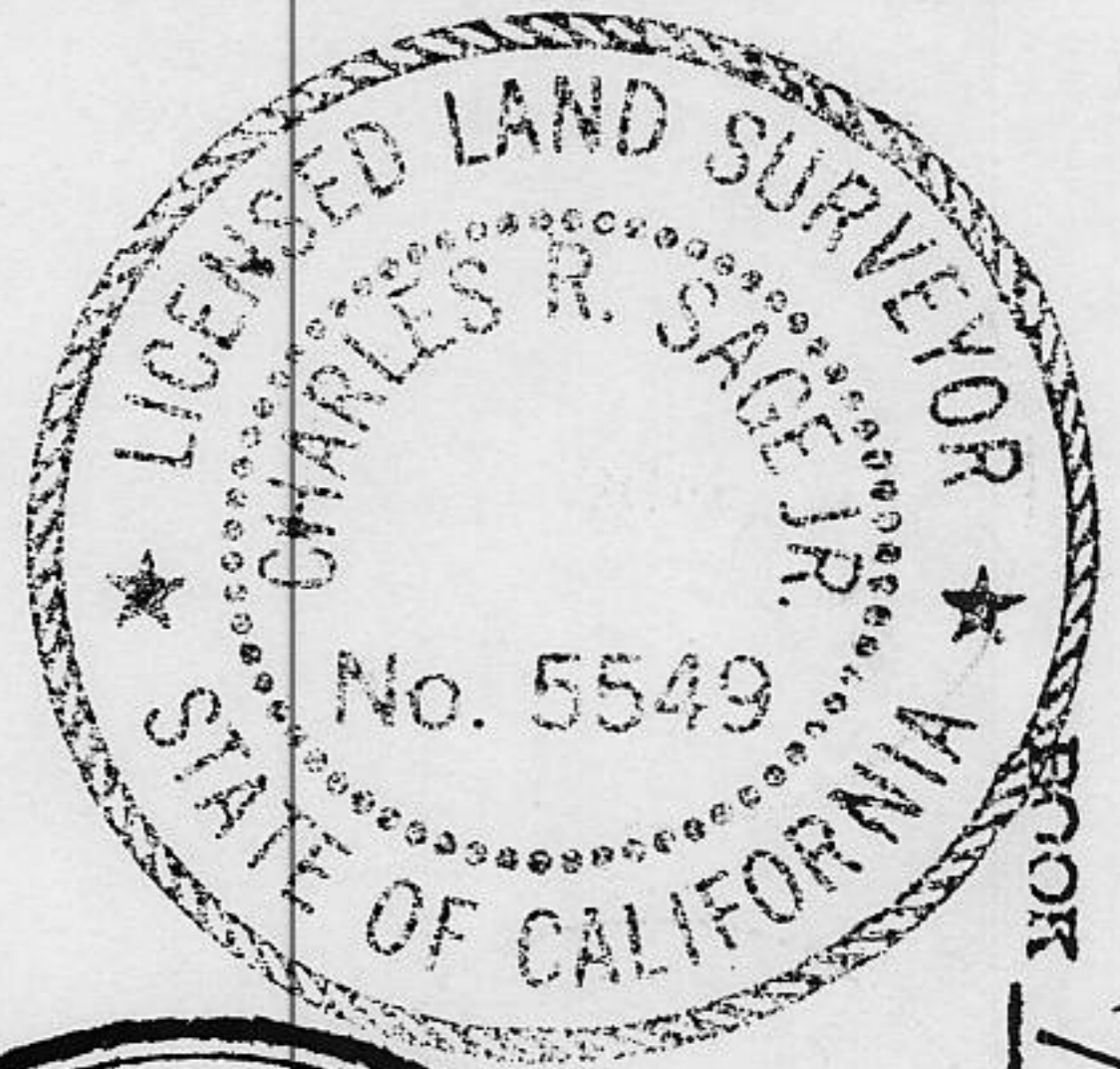

FOR CORNER RECORDS PAGE 9



NOTE: THE BEARINGS AND DISTANCES SHOWN ARE RECORD PER "I" MAPS/53. NO MATERIAL DISCREPANCIES WITH RECORD INFORMATION WERE FOUND.

